

March 14, 2025

Yazaki Energy System Corporation

## Taxi tablet that can be linked with the taxi meter and implement multiple services Yazaki's Y-Tab1 Tablet for Taxis Begins Service

Yazaki Energy System Corporation (Head Office: Minato-ku, Tokyo; President: Wataru Yazaki) will launch its Y-Tab1 taxi tablet service on March 14. Y-Tab1 can be used with multiple in-taxi dispatch applications, and can also be linked to the taxi meter to improve driver operations.

Currently, the taxi industry is seeing an increase in tablet-based services. As a result, multiple tablets are being used within the taxi driving environment, creating issues such as having to secure cabin space for additional equipment and complicating driver operations.

To solve these issues, this new taxi tablet offered by Yazaki has been designed to allow the driver to use multiple dispatch applications on a single tablet. As well as reducing the operational burden on the driver, more dispatch applications can be deployed to increase sales opportunities while also taking driver safety into consideration. The expansion of functions to services other than vehicle dispatch applications is also currently under consideration.

### [Yazaki's Y-Tab1 Tablet Solution]

- Using a single tablet for multiple vehicle dispatch applications reduces the amount of space required for installing devices.
- Linking the taxi meter information with the app implemented by Yazaki enables some tablet operations to be eliminated, improving the convenience of the app.

### [Image of the Yazaki Tablet's Vehicle Dispatch Application Linked with the Taxi Meter]

The taxi meter statuses such as occupied, vacant, return (to depot), and in route (to passenger) are linked to the taxi dispatch application, eliminating the need to switch between accepting and rejecting taxi dispatches on the taxi dispatch application.

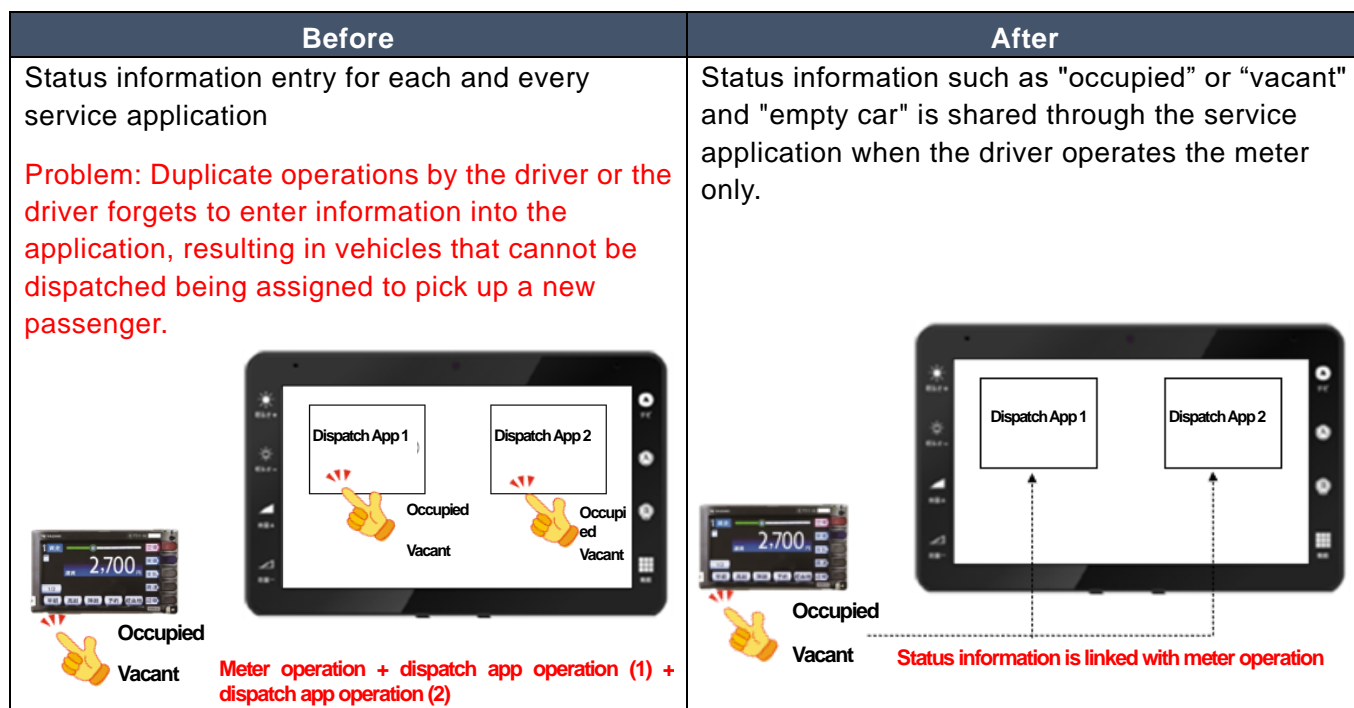

## [Image of Implementation of Yazaki Y-Tab1 Tablet]

Yazaki Y-Tab1 Tablet for Taxis

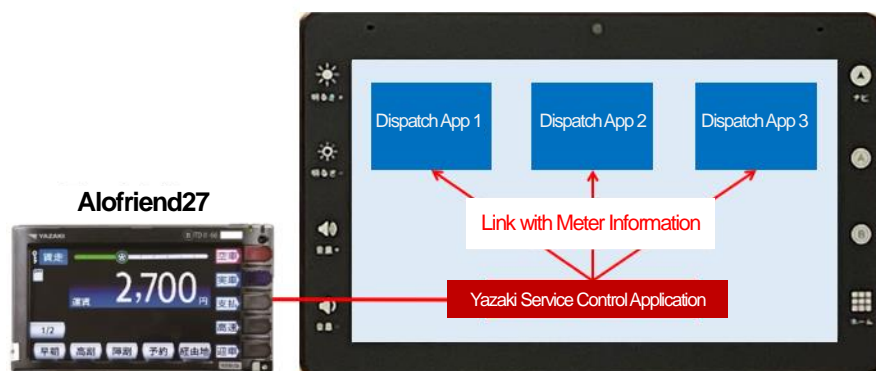

- The taxi meter that can be linked to the Yazaki Y-Tab1 Tablet is the Alofriend 27 model. The taxi meter and peripheral devices must be purchased separately.
- Applications to be used on the tablet need to be modified in order for the application to link with the taxi meter information.
- Specifications are subject to change without notice due to product improvement.

## [Yazaki Tablet Applications Planned for Implementation (as of March 2025)]

Denno Kotsu Inc., DiDi Mobility Japan Corp., S.RIDE Inc., REA Inc.

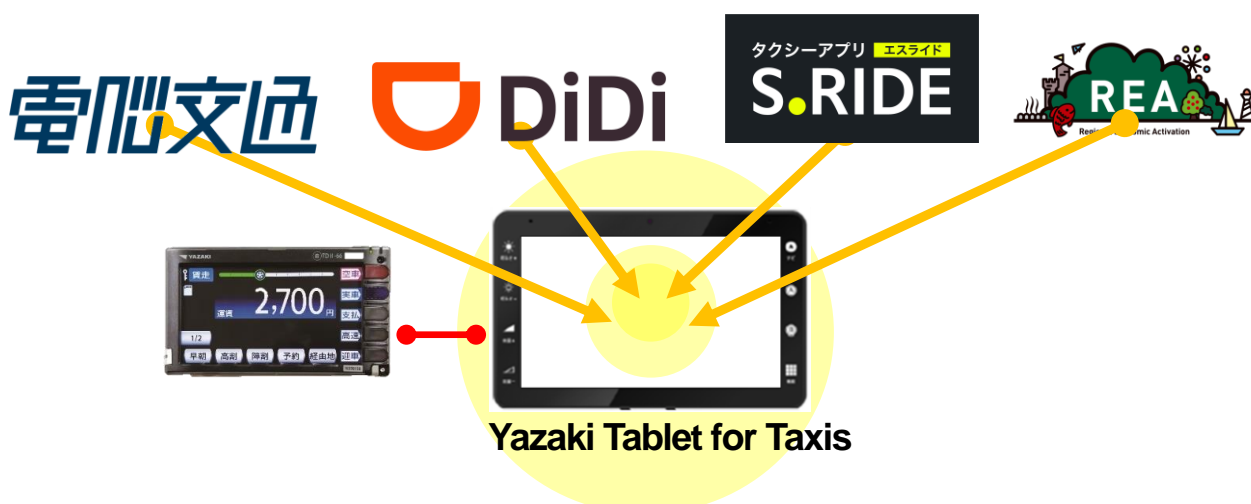

Note 1: Taxi operators are required to sign a contract with each application company in order to use the service.

Note 2: Please refer to our website for detailed information on Yazaki tablets and the latest information on applications that can be implemented.

<https://www.yazaki-group.com/keiso/products/ytb1/index.html>

Note 3: Models may be changed without notice due to market changes.

Note 4: Applications must be modified to link with the taxi meter information, and not all applications that can be implemented are capable of linking with taxi meters.

Please consult with our sales staff for details on taxi meter-linked applications.

### Inquiries

Yazaki Energy System Corporation  
Mobility Business Headquarters, Instrumentation Sales & Marketing Division  
Tel.054-283-1156